

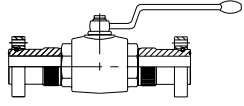

Valves - Visual Index

RETAIN RING FLANGED BALL VALVE ASSEMBLY	<p>A/BV ASSEMBLY</p>  <p>1/2" - 2" Page P3</p>			
CHECK VALVES	<p>CV RETAIN RING FLANGE STYLE</p>  <p>1/2" - 2" Page P4</p>	<p>A/CV RETAIN RING FLANGE STYLE ASSEMBLY</p>  <p>1/2" - 2" Page P5</p>		

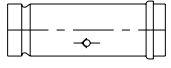
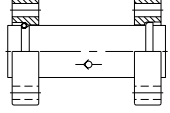

Retain Ring Flanged Ball Valve Assembly

Complete Assembly Part Number

Typical A/BV Assembly

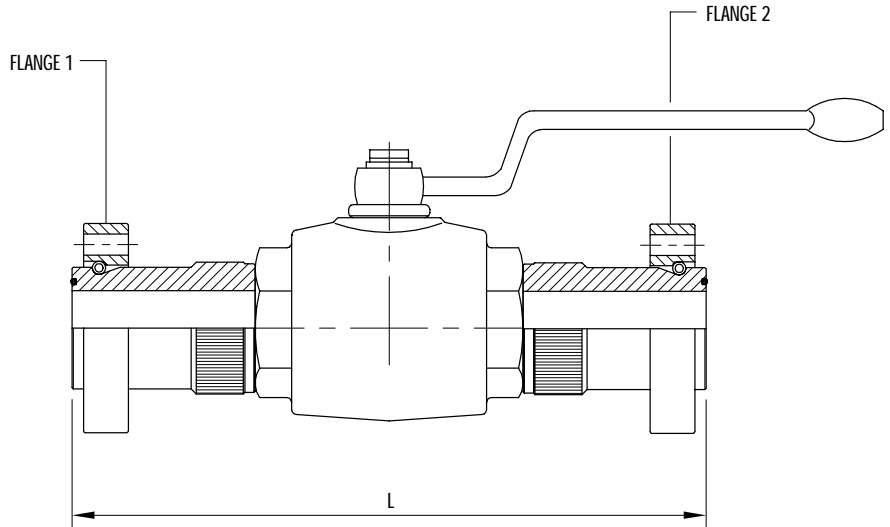

COMPLETE ASSEMBLY CONSISTS OF:

- ONE (1) FEMALE SAE THREADED BALL VALVE BODY
- TWO (2) MALE SAE THREAD ADAPTERS (REF. PAGE F2)
- TWO (2) RETAIN RING FLANGES (REF. PAGES C8-C9)
- TWO (2) RETAIN RINGS
- BUNA 'O' RINGS (FLANGE ENDS)

		Code	A	BV	Ball Valve Size	Flange 1	Flange 2	Options
Assembly		A						
Ball Valve		BV						
Ball Valve Size	1/2"	050						
	3/4"	075						
	1"	100						
	1 1/4"	125						
	1 1/2"	150						
	2"	200						
Flange Type <small>Carbon Steel Yellow Zinc Dichromate Plated Ref. pages (C8-C9)</small>	RFC34 ISO 6162-1 W/Clearance Holes	FC34						
	*RFTM34 ISO 6162-1 W/Tapped Holes	FTM34						
	RFC64 ISO 6162-2 W/Clearance Holes	FC64						
	*RFTM64 ISO 6162-2 W/Tapped Holes	FTM64						
Options	LOK-Locking Device	LOK						
	Viton	V						

Size	Dimensions (mm)
	L
1/2"	216.7
3/4"	234.7
1"	265.4
1 1/4"	275.8
1 1/2"	345.9
2"	355.8

* NORMALLY USED FOR CONNECTION TO SPLIT FLANGE TYPE ENDS

• FOR CONNECTION TO HOSE USE CONNECTOR PLATE OCP (TO BE ORDERED SEPARATELY) REFERENCE PAGE C17

PART NO. (EXAMPLE): A/BV - 050 - FC34 - FTM34

- ASSEMBLY WORKING PRESSURE RATINGS ARE SUBJECT TO THE LESSER OF THE FLANGE OR BALL VALVE RATINGS
- SEE REFERENCE PAGE INDICATED ABOVE FOR PRESSURE RATINGS
- OTHER MATERIALS ARE AVAILABLE
- FOR BOLT KITS - REFERENCE SECTION R

Check Valve

Retain Ring Flange Style - Body Only

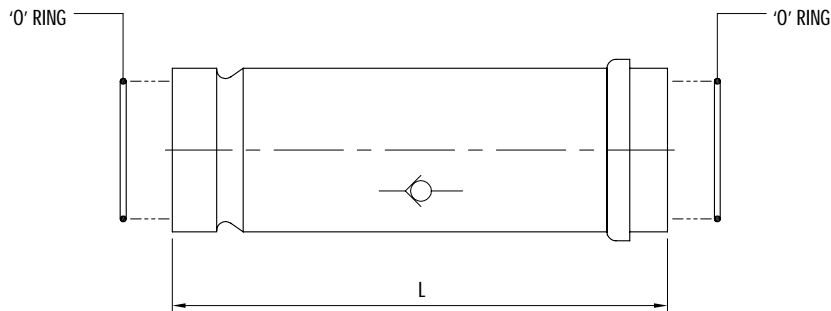

CV Check Valve Body - Poppet Style

Complete with Buna 'O' Rings (Standard)

Size	Check Valve Part No.	Dimensions (mm)	'O' Ring (Buna) Part No.	WT. kgs/pc	Working Pressure (Body Only) BAR
		L			
3/4"	CV-075-07-*	91.4	OR*-3-913	.59	350
1"	CV-100-07-*	111.8	OR*-3-916	.76	350
1 1/4"	CV-125-07-*	131.6	OR*-3-918	1.14	350
1 1/2"	CV-150-07-*	146.3	OR*-3-924	1.93	350
2"	CV-200-07-*	171.2	OR*-3-928	2.55	350
2 1/2"	CV-250-07-*	181.4	OR*-2-232	4.09	350
3"	CV-300-07-*	191.3	OR*-2-237	6.21	350

Opening Pressure		
	PSI	(bar)
Standard	7	(0.5)
Optional	21	(1.5)
Optional	43	(3.0)

* INSERT 'V' TO INDICATE OPTIONAL VITON 'O' RINGS

• TO ORDER A COMPLETE CHECK VALVE ASSEMBLY REFERENCE PAGE P5

MATERIAL: CARBON STEEL, YELLOW ZINC DICHROMATE PLATED, (STAINLESS STEEL AVAILABLE)

Performance Curves: Measured using oil at 190SUS and 50°C

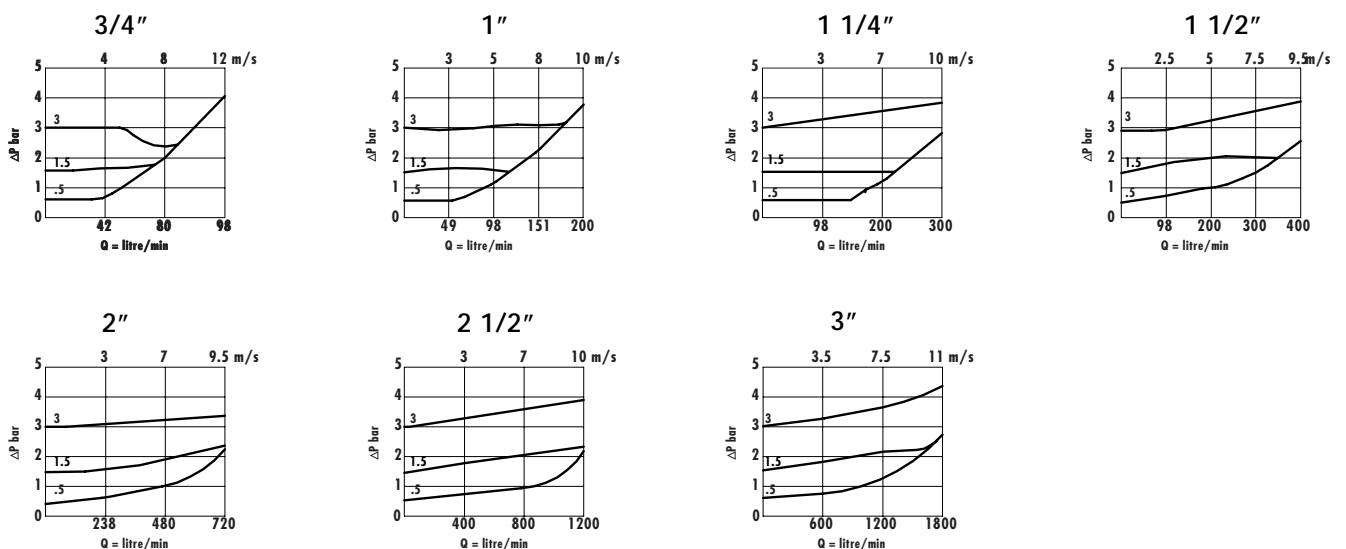



Check Valve Assembly

Complete Assembly Part Number

Typical A/CV Assembly

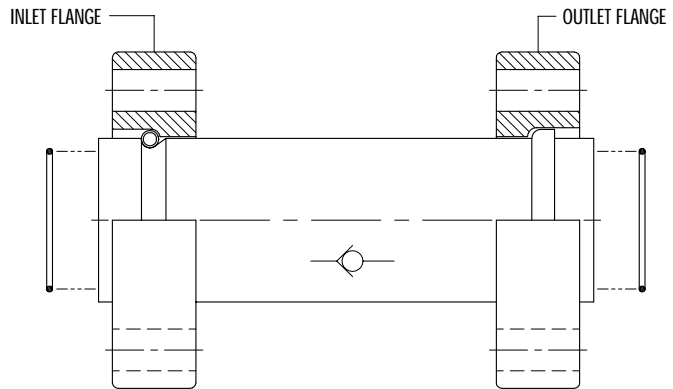

COMPLETE ASSEMBLY CONSISTS OF:

- ONE (1) CHECK VALVE BODY - POPPET STYLE (REF. PAGE P4)
- TWO (2) RETAIN RING FLANGES (REF. PAGES C8-C10)
- ONE (1) RETAIN RING
- BUNA 'O' RINGS (STANDARD)

		Code	A	/	CV	-	Valve Size	-	Inlet Flange	-	Outlet Flange	-	Opening Pressure	-	Options
Assembly		A													
Valve Body Ref. page (P16)	Check Valve	CV													
Valve Size	3/4"	075													
	1"	100													
	1 1/4"	125													
	1 1/2"	150													
	2"	200													
	2 1/2"	250													
	3"	300													
Flange Type Carbon Steel Yellow Zinc Dicromate Plated Ref. pages (C8-C10)	RFC34 ISO 6162-1 W/Clearance Holes	FC34													
	*RFTM34 ISO 6162-1 W/Tapped Holes	FTM34													
	RFC64 ISO 6162-2 W/Clearance Holes	FC64													
	*RFTM64 ISO 6162-3 W/Tapped Holes	FTM64													
	RFC74 ISO 6164 W/Clearance Holes	FC74													
Opening Pressure	0.5 BAR - Standard	07													
	1.5 BAR - Optional	21													
	3.0 BAR - Optional	43													
Options	Viton	V													

Opening Pressure		
	PSI	(bar)
Standard	7	(0.5)
Optional	21	(1.5)
Optional	43	(3.0)

* NORMALLY USED FOR CONNECTION TO SPLIT FLANGE TYPE ENDS

• FOR CONNECTION TO HOSE USE CONNECTOR PLATE OCP (TO BE ORDERED SEPARATELY) REFERENCE PAGE C17

PART NO. (EXAMPLE): A/CV - 075 - FC64 - FTM64 - 07

- ASSEMBLY WORKING PRESSURE RATINGS ARE SUBJECT TO THE LESSER OF THE FLANGE OR THE CHECK VALVE RATINGS
- SEE REFERENCE PAGE INDICATED ABOVE FOR PRESSURE RATINGS
- OTHER MATERIALS ARE AVAILABLE
- FOR BOLT KITS - REFERENCE SECTION R



